



CLINTON COUNTY TRAILS



Published Quarterly

December 2018

Volume 33 - Issue 4

Historical Society

President – Lynne Gregory
 Vice President – Julie Peters
 Secretary – Gayla Phillips
 Treasurer – Rowlan Smith
 Directors:
 Ron Matson
 Myrna VanEpps
 Wayne Summers

Paine-Gillam-Scott Museum Board

Director– *Vacant*
 Asst. Dir. - Bill McCarthy
 Secretary - Brian Grennell
 Treasurer - Jan Upton

CCHS Archives

Director – Julie Peters

Newsletter Co-Editors

Lynne Gregory
 Kim Sperry

Contents.....	Page
Brotherhood of the Round	
Table.....	37
Austrian Research.....	38
Essex Twp. Occupation 1870...39	
Seth P. Marvin ,.....	41
Hayworth Drain Extension.....	42
Back Thru the Years.....	44
Recent Acquisitions.....	45
The Clinton House.....	46

Brotherhood of the Round Table

Contributed by Wayne Summers

The Brotherhood of the Round Table (BOTRT) was organized as Sunday school class No. 6 of the St. Johns Methodist Episcopal Church in 1904 by **Ida (Hicks) Rawson** (later Bishop). The daughter of **Mr. and Mrs. John Hicks**, she was actively involved in the church and traveled extensively to various church conferences throughout the world.

The BOTRT was organized for young men age 16 and up. The first meetings were in Ida Rawson’s home on Friday nights with a handful of students including **Carl V. Weller, W. H. Osgood, and E. G. Hulse**. As they sat around a round table it was agreed they would call themselves the Brotherhood of the Round Table. The class grew and began meeting at the church on Sundays at noon. Active members that aged out or moved became honorary members and were invited back for annual banquets.

In 1909 **Mrs. Rawson** purchased a building across the street at 107 East State Street as a meeting place open daily and equipped with a piano, books, tables, games, and a kitchen. Known as the Reading Room, it also featured tennis courts located just west of the building in a 25’ by 75’ space. They were open to girls two days a week and flooded during the winter for skating.

Extensive records and notes kept in a large leather-bound book she designed and had printed show the meticulous manner in which **Mrs. Rawson** conducted the class. She also printed calling cards, stationery and envelopes, annual reports, and programs for special meetings and events.

During her tenure as teacher, **Mrs. Rawson** was noted for the gifts and attention she gave her students. Every year each boy was given a copy of Peloubet’s Select Notes, an annual Bible lesson book. They also received birthday and Christmas greetings and a set of solid silver teaspoons upon their marriage. The records list 112 members from 1904-1911 during the time **Mrs. Rawson** led the class.

Due to poor health, **Mrs. Rawson** handed the class over to **C. N. Roberts**, the blind church organist, in July 1911. At that point record keeping decreased and then ceased after a 1915 membership list showing 31 members compiled by the teacher, Tom Stead. Neither the record book nor **Mrs. Rawson’s** notes for the 1938 dedication of the new church record when the class dissolved.



Brotherhood of the Round Table Membership list 1904-1915

Allison, Orlie	Finch, Julius	Lyon, Harry G.
Allward, G.	Fletcher, Gilbert W.	Marshall, Schuyler L.
Alward, Edward	Foerch, Ole J.	Mason, Dana M.
Barnes, L. H.	Footitt, Frank F.	McClintock, F.
Black, Claude R.	Furman, John W.	McKinstry, Archie
Black, Harry D.	Graham, C.	McMannis, Harry E.
Black, Merlyn	Grubaugh, Lawrence	Mead, Lester E.
Bond, Archie C.	Grubaugh, Leon	Montgomery, Charles
Botsford, Clark C.	Hackett, L. B.	Morris, Rich.
Bowles, Hugh E.	Hall, Clarence A.	Morrison, M. W.
Bretton, Charles	Hallock, Floyd G.	Mulder, Arthur
Brewbaker, Lee	Hart, Lee	Osborne, Earl
Brown, Harry B.	Helmar, Robert	Osgood, George E.
Burbank, Clifford	Henderson, H. Glenn	Osgood, Glenn
Burnett, Verne	Henderson, Ralph R.	Osgood, W. R.
Carrington, Harry W.	Henderson, Robert G.	Osgood, William
Carter, Ross L.	Hendes,	Osgood, William H.
Casteel, Don	Hicks, Don C.	Palmer, Leon
Casteel, Sam C. W.	Hill, Fred	Parker, Anson R.
Cavanaugh, F. B.	Hodge, Dart H.	Parmalee, Edward
Chase, Henry W.	Horn, William B.	Parr, Lyman D.
Clark, Myron	Howard, Allen B.	Pinckard, J. B.
Coats, Monroe E.	Hulse, Edward G.	Plowman, Forest
Coleman, LeRoy	Hulse, Harry A.	Post, F. L.
Corkin, Edward	Hulse, L.	Putman, William T.
Corwin, Geo.	Hulse, Leon	Putnam, Harold
Corwin, George	Hyatt, Ralph G.	Putnam, Harold A.
Craig, Walter A.	Johnson, A. V. Leonard	Putnam, Marcus
Crampton, Earl	Karcher, Howard	Putnam, William
Crampton, L.	Kelly, Myron J.	Putt, Fenimore
Crawford, Samuel	Krell, Adolph J.	
DaFoe, Louis A.	Lattimer, Irvin	
Darland, LeRoy	Leddick, A. B.	
Davis, James F.	Leeson, Clyde C.	
Downs, Mylo B.	Lewis, Clyde T.	
Eagle, Verne	Loomis, Robert	
Fegore, R. I.	Loree, M.	

Find Austrian, Czech, and Slovenia Places with GenTeam

Contributed by Lynne Gregory

Genealogists with roots in Austria or the Czech or Slovenian Republics may well want to check out the gazetteer database of GenTeam <https://www.genteam.at/> It includes some 72,000 locations in Austria and in the Czech and Slovenian republics. It contains former and present names of locations, current and former parish affiliation, year that existing records begin, archival districts, and political districts or crownland. If you are uncertain about the correct spelling of a location, you may also search for a portion of its name. This will produce a larger number of results, and also to the correct village. Other name searchable databases on this site include a selection of Roman Catholic Baptisms and Marriages, Protestant records, Seignoral Indices, Lodges, Memorial Cards, and more. The site is free to use, but registration is required. By Lisa Alzo, *Internet Genealogy* and *Your Genealogy Today* author.

Note: This author has also written an excellent research book: "The Family Tree, Polish, Czech & Slovak Genealogy Guide. How to Trace your Family Tree in Europe." It is full of resources, language helps, forms & more.

ESSEX TWP. OCCUPATIONS IN 1870

Contributed by Myrna VanEpps

The 1870 census states the occupation of each adult in Essex Twp. The large majority of men are farming and the women are keeping house. One hundred twenty-one others busy themselves with different jobs or professions as shown on the following list.

Occupation	Person
Carpenter	Antes, Newton G
Teacher	Benjamin, Libbie
Milliner	Bennett, Mianda
Teacher	Bentley, Margaret
Shoemaker	Bond, James
Minister	Branch, Edwin F
Merchant (General)	Brown, Lafayette
Minister	Cadwell, Jason
Physician	Cadwell, May
Planing Mill Proprietor	Carpenter, James
Wagonmaker	Case, Calvin P
Wagonmaker	Case, Marcus
Teacher	Chase, Nancy
Jeweler	Church, Richard
Harness Maker Apprentice	Cook, Andrew
Carpenter	Cook, Thomas
Stage Proprietor	Craig, Cyrus
Druggist	Cresinger, Barnard
Teacher	Cresinger, Laura J
Drug Store Clerk	Cresinger, Seth E
Druggist	Cresinger, Solomon P
Surveyor Assistant	Danly, Newell
Mason, Stone & Brick	Davison, Andrew
Teacher	DeLong, Allen
Teacher	DeLong, Nelson Jr
Shoemaker	Dennis, David R
Tinsmith Apprentice	DeWitt, John J
Carpenter & Joiner	Dodge Charles
Teacher	Dowd, Loranda
Painter	Fay, Alfred
Painter	Fay, William
Physician	Fox, Albert
Harness Maker	Frederick, William
Shoemaker	Hartman, Daniel
Teacher	Hause, Lucinda
Dentist	Hawley, Theodore P
Merchant, Dry Goods	Hewitt, Isaac
Merchant, Dry Goods	Hewitt, Joseph
Cabinet Maker	Hewitt, Rufus H
Grist Mill Proprietor	Hewitt, Simeon
Sawmill Proprietor	Hewitt, Zachariah N
Merchant	Hill, Simon
Carpenter	Histed, Henry E
Teacher	Horr, Stephen C
Carpenter	Hoyt, Lucien
Carpenter	Hoyt, Theodore P
Carpenter	Hubbard, Erastus C
Carpenter	Hudson, Franklin
Blacksmith Apprentice	Ingraham, Hetman A
Cooper	Ingraham, Solomon
Carpenter	Jaek, Alonzo
Carpenter	Jeffreys, Caleb
Dressmaker	Jennison, Rosabel
Lumberman	Jones, Adolphus
Blacksmith	Jones, James H
Lawyer	Kimball, John
Artist	Knowles, Weston O
Teacher	Lamphere, Alice
Physician	Lestervelt, John C
Artist [Photographer]	Lyon, Elias W
Agent, Nursery	Lyon, Samuel A
Drover	Martin, James W
Physician	Martin, Patrick
Painter	Mattoon, Gershon P
Blacksmith	McCracken, Samuel
Teacher	Moss, Arthur H
Merchant, Dry Goods & Groceries	Moss, Edgar D
Minister & Co. Supt of Schools	Mudge, Elisha
Carpenter	Niver, Charles
Dressmaker	Ovens, Rosa
Stock Dealer	Owens, James
Sawmill Head Sawyer	Panny, Nathan
Merchant, Hardware	Peck, Orrin F
Tailor	Percy, Perry S
Merchant, Dry Goods	Petteys, William F
Mason, Stone	Quick, Alexander
Hotel Keeper	Reed, Samuel
Carpenter	Richard, Daniel

Weather Warning!

Contributed by Lynne Gregory

Mother Nature seems to have been throwing temper tantrums all over the world these last few years, and with increasing frequency.

Family and local historians should take seriously where to store your “treasures”, old photos, files, documents and notes, memorabilia and family valuables. Even if living on higher ground, basements can flood from burst pipes, sewer backups, or other sources. Attics can flood from roof leaks or become so hot in the summer as to change papers into crisp shards and photos fade. Fires on any floor can burn flammables and ruin valuables or cause water damage.

Floods can also carry houses away, fires & wind related storms can destroy all your research and valuables.

You may say, “I have it all on computer so it is safe,” BUT, what happens in a few years when technology has changed and today’s records cannot be accessed? Are computer documents & photos as valuable to you as they are to your grandparents, who held these in their hands? Are “valuables” your ancestors made with their own hands or had in their homes only valuable to you as a computer photo?

Please remember some other family members may really treasure all the originals of photos, letters, etc. and it is up to you to be responsible for saving and protecting your research in all forms.

A fireproof/waterproof safe, in your home or off site in a secure fireproof/waterproof storage area can protect things if you know bad weather is coming or you just want to protect things.

And always remember too, that if family/local history things you discover are not valuable to you – don’t destroy – ask family members or local historical and genealogy societies if they would like them.



Teamster	Richards, William H
Teamster	Richmond, George A
Painter	Richmond, Hiram
Painter	Richmond, Merwin
Wagonmaker	Richmond, Orrin D
Mason, Stone	Richmond, Wells W
Druggist	Root, Edwin N
Druggist	Root, Starr M
Physician	Sanborn, Rodolphus
Musician [violinist]	Schank, Lyman B
Wagonmaker	Seabring, Rudolph
Sawmill Worker	Shaw, Alfred
Cabinet Maker Apprentice	Sigsby, Jolly
Mason, Stone	Sigsby, Newton
Carpenter & Joiner	Skinner, Benjamin L
Merchant, Dry Goods	Smith, Edgar M
Hotel Servant	Smith, Frances
Sawmill Worker	Smith, Frank
Saloon Keeper	Smith, Sanford W
Sawmill Worker	Smith, Sanford W Jr
Teacher	Stevens, Emma
Sawmill Engineer	Taylor, Clayton
Carpenter	Terry, Horace
Blacksmith	VanHoesen, John
Carpenter & Joiner	Vreeland, Orrin L
Teamster	Webster, Carlos A
Blacksmith Apprentice	Webster, Charles
Blacksmith	Webster, Martin
Mason, Stone; apprentice	Wells, Dallas
Merchant, Dry Goods	Wells, John
Foundry Proprietor	Whitacre, John N
Teacher	Whitacre, Mary E
Engineer	Whitacre, Matthew J
Carpenter	White, George L
Sawmill Worker	White, John
Carpenter	Whitney, Hiram
Butcher	Whitney, Russell
Teamster	Wilcox, George T
Moulder	Wilcox, Lewis R
Moulder	Winans, Charles E
Agent, Insurance	Wolverton, Joel S
Gunsmith	Yates, Jemiah B
Carpenter & Joiner	Young, William

Seth P. Marvin, a Life of Triumphs and Tragedy

Contributed by Wayne Summers

They say behind every great man is a woman. But what happens when that woman is no longer there? **Seth Perkins Marvin** was born on August 15, 1811, in Bloomfield, Ontario County, New York. He traveled with his family to Oakland County, Michigan, by way of Ohio. From there he settled in Watertown Township, just west of the settlement of DeWitt with his father, **Calvin Marvin**, and two brothers **Eleazer and Asahel**. There Seth built a log cabin home for himself and prepared to begin what would be a life journey full of both success and heartache.

While having no formal medical training, on November 14, 1836, he secured a license to practice medicine from the Medical Society of the County of Macomb. Upon showing this certificate, the Central Michigan Medical Society admitted him as a member. License in hand he opened a medical practice, becoming the first doctor in Watertown Township and second in DeWitt.

It wasn't long before **Betsey Gooch**, a teacher at the first school in the DeWitt area, caught his eye. **Betsey** had traveled to DeWitt with her sister, **Mary Ellen** (soon to become the wife of prominent lawyer **Randolph Strickland**), and later followed by a third sister, **Olive**, who married **Stephen Hill** and settled in Watertown Township. **Betsey** and **Seth** were married July 11, 1838, and moved to DeWitt.

In addition to his medical practice **Seth** was very active in public office. Serving as a school inspector for several years beginning in 1838, he helped start a school in DeWitt and even acted as its teacher for a short while.

On April 10, 1839, he was elected Clinton County's first clerk. With the construction of the new county jail lagging, **Seth** stepped in and saw to its completion. After finishing his term as county clerk, he served as Clinton County Register of Deeds for three terms.

Just as a lack of formal medical training was not an impediment to him becoming a doctor, an absence of legal training did not deter him from being elected Judge of Probate in 1856 for a four-year term.

During his time of public service, he established a reputation as not only a good father and husband, but also a kind man of great integrity, with an excellent intellect. He was also praised as a good conversationalist and excellent storyteller. This changed in 1860.

While he had had continual professional success, his personal life had been marked with sorrow. **Betsey** and **Seth** had nine children and buried six. Then on June 6, 1860, **Betsey** passed away leaving **Seth** with two boys, **Deforest** (19) and **Delos** (14), and a 4-year-old girl, **Allie**.

Seth began to suffer from periods of deep depression which became both more frequent and intense. He tried to get on with his life by remarrying a widow, **Mariette Adams**, who had three children of her own. That didn't help. Hoping that getting away from DeWitt would bring relief he moved to Corunna and opened a drug store. Before long he abandoned the store and headed to west Michigan in search of contentment.

Returning to Clinton County briefly with the stated intent of returning to west Michigan, he paid a visit to his brother and sister-in-law **Randolph and Mary Ellen (Gooch) Strickland** in St. Johns on Monday, August 15, 1864.

During the visit **Seth** left the **Strickland** house for the stable to care for the horses. With tea time approaching, the **Strickland**'s sent their young daughter out to fetch him. She returned very upset, saying her uncle was sitting and not moving.

Rushing to the stable they found **Seth** seated on a box with a cord wrapped around his neck and fastened to a peg several feet above his head. The coroner was called and pronounced the death a suicide.

His body was laid to rest next to **Betsey** in the DeWitt Cemetery in an unmarked grave. Of his three living children, the two older boys were old enough to be on their own, but young 8-year-old **Allie** was taken in and raised by **Seth**'s sister, **Mary McArthur**.

The oldest son, **Deforest Gooch Marvin**, served for a time in Company D of the 1st Lancers in the Civil War. After the war he worked as a printer and died having never married in Dimondale on November 16, 1918, of heart disease.

The younger son, **Clarence Delos Marvin**, lived in Grand Rapids, Michigan, most of his life and also never married. In his later years he appears to have suffered from many of the same afflictions as his father. In January of 1920 he left the Kent County Detention Hospital and traveled to Portland, Oregon, where his sister who he hadn't seen in 15 years was living. Upon arriving, he wandered around the train station in a confused state until police picked him up and took him to the police emergency hospital. There a nurse was able to connect him with his sister who had contacted the police in search of her brother. On March 17, 1920, like his father he committed suicide by hanging himself.

Allie, the youngest daughter, appears to have left Grand Rapids at some time after the death of her aunt **Mary (Marvin) McArthur** in 1901. Piecing together scanty scraps of information, she seems to have lived in Delmont, South Dakota, and Mattison, Colorado, before settling in Portland, Oregon by 1919. At that time she is mentioned in a newspaper article as being from the Pisgah Home. The Pisgah Home movement had been founded by **Finis E. Yoakum** and provided shelter and care to the homeless. It's uncertain if she was helping care for the homeless or a homeless person herself. After the death of her brother Clarence in 1920 no additional record or mention of her has been found.

Thus ended the life and progeny of one of the men instrumental in the early development of Clinton County. One can't help but wonder if his story and that of his children would have been different if the woman in his life had not died.

Notes: Betsey and Seth had nine children: Marshall Dewitt Marvin (25Jul1839-27Feb1848); Deforest Gooch Marvin (2Feb1841-16Nov1918); Mary Elizabeth Marvin (29Jul1843-26Sept1843); Charles Henry Marvin (31Mar1845-19Apr1846); Clarence Delos Marvin (2Apr1846-17Mar1920); Amos C. Marvin (c1849-17Aug1850); Lucy A. Marvin (c1850-11Sep1853); Frederick C. Marvin (c1853-31Oct1854); Alice "Allie" M. Marvin (c1856-aft 1920).

HAYWORTH DRAIN EXTENSION

Construction of the dredge and boats for work on the extension to the Hayworth Drain Extension has been going steadily on and it is expected that the actual work will be started shortly. The machinery is being drawn out and cabins finished. There is one cabin, which floats and is being built on a boat 14' wide by 30' long, which will be for the use of the cooks. Another is a houseboat with sleeping apartments, dining room, and kitchen, all equipped like a real home for the convenience of those employed. This will probably be about 12 persons. The large boat for the machinery, which is 85' long x 30' wide is, at the present time, in the course of construction and is now about ready to launch and to have the machinery installed, 30 tons of which is now on the ground and about 40 tons more on the road.

There has been delivered upon the ground about 67,000' of lumber and timber for constructing the boats and buildings necessary to carry on the work. It is expected that, if there is no delay in shipment of the material yet to come, the actual construction of the drain itself will commence sometime between the first and middle of December or even earlier if everything is favorable. The equipment for the work on the Hayworth Drain Extension is thought to be one of the largest in this part of the state and the largest inland dredge in Michigan.

The dredge is being built on the **DeFore Bottum** farm in Essex about ½ mile south of the Lowe Church and all people interested in the kind of work being done on the drain are cordially invited to visit the scene of operations at any time and are welcome to inspect the work and methods of construction of the drain. **Louis F. Green** [Co. Drain Commissioner] thinks that it would be worth the effort of anyone to get an idea of the cost of the Hayworth Drain. Mr. Clifton, an expert travelling for the Fairbanks Steam Shovel Co. of Marion, Ohio, came here Tuesday to take care of installing the machinery. *Clinton Republican*; 9 Nov 1916, p1

* * *

Residents in the vicinity of the **DeFore Bottum** farm, Essex Twp. were all present on Wednesday to assist in the launching of the big boat to be used for the dredging machinery for the Hayworth Extension Drain. The

boat is 30' wide x 80' long. It contains about 55,000 feet of lumber and a carload of bolts and has been a couple months in construction. It was built on the creek bank and was pushed into the pond prepared for it, down greased ways about 40' long. A dam has been built in the creek and a pond over 100' long has been formed to float the boat. The boat will carry the largest dredging outfit ever used in the county. The machinery is now being installed. The huge boiler and one of the engines have already arrived and the remainder is expected every day. Two more engines are to come and the big boom which is about 75' long.

Two house boats were erected before the big boat was commenced to accommodate the workmen during its construction. One of them, which is about 12' x 30' is used by the cook and his family for their home and for the dining room of the entire crew. The other is 12' x 24' and is used as a bunk house.

“Dad” Anderson, the man who supervised the building of the boat, and Ernest Berry, the foreman of the work, wish, in the name of the Woolman Construction Co., to thank the gentlemen of the neighborhood who so generously helped on the launching of the boat. *St. Johns News*; 16 Nov 1916; p1

* * *

The last of the machinery for the Hayworth Extension Drain has been unloaded and actual dredging of the waterway will begin very soon. The machinery is all that was shipped in as the dredge and houseboats were constructed here. Mr. Clifton, an expert travelling for the Fairbanks Steam Shovel Co. of Marion, Ohio, came here Tuesday to take care of installing the machinery. *Clinton Republican*; 14 Dec 1916, p1

North Branch of Hayworth Creek; Essex Twp.; 1915

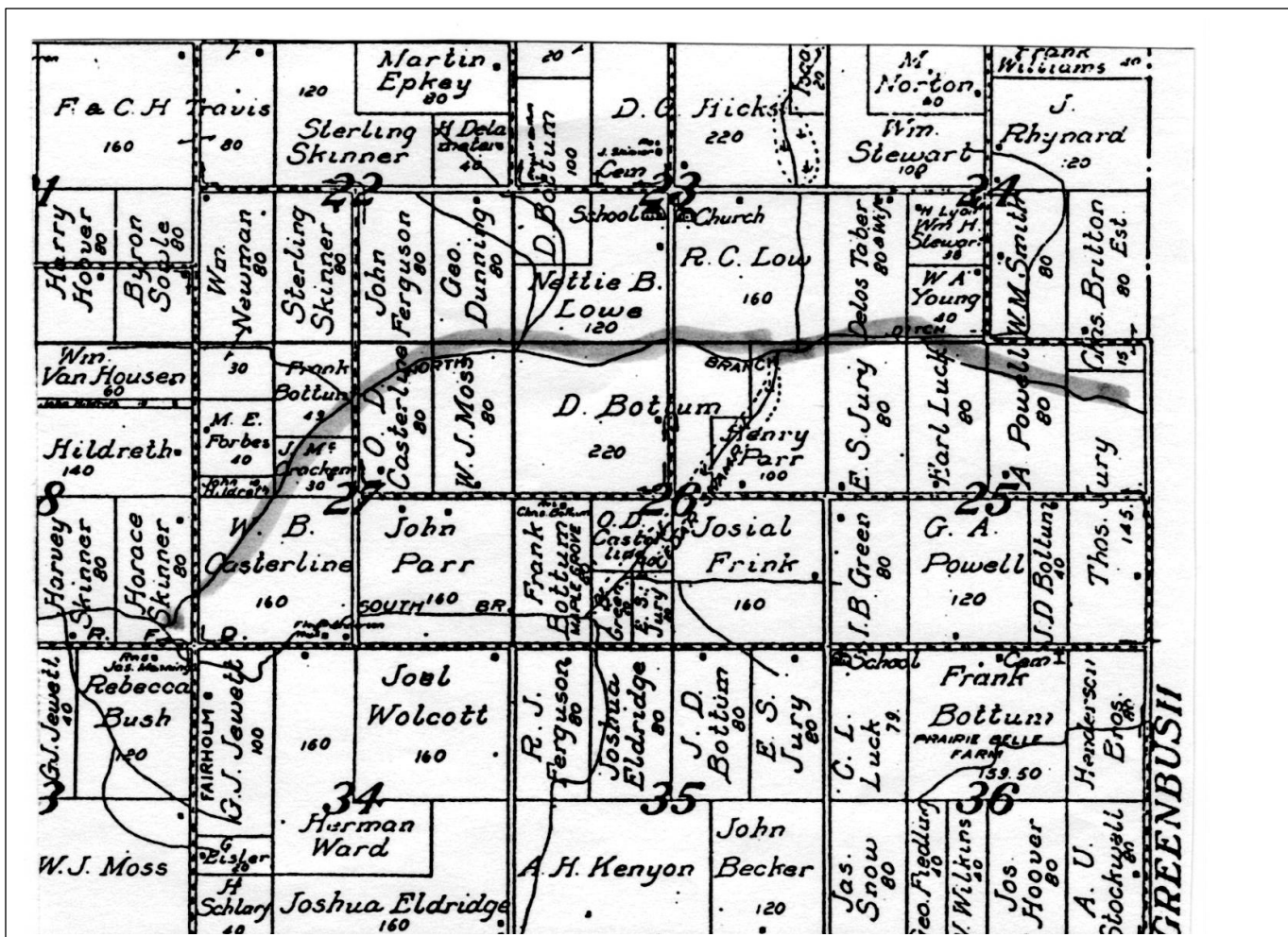

BACK THROUGH THE YEARS

A plucky Michigan maiden chased a robber with a pitchfork and made him drop his plunder, and she is now receiving offers of marriage at the rate of fifteen per week.

(CR 22 Mar 1888 p4 c3)

A few weeks ago we were pained to hear of the accidental shooting of one of the most respectable members of the community. As **George Kimble**, very much excited by the glimpse of what he took to be a fine rabbit in the distance, fired and something dropped, but, instead of the rabbit, it proved to be his fine watch-dog, Tony. Mr. Kimble was almost prostrated by the accident, but it is thought that both Mr. K and his dog will recover.

CR 29 Mar 1888

NOTICE

Rubber Crome flexible soles will outwear two common soles.

Call and see a sample.

Electric Shoe Shop

M. W. Thomas, Prop.
Clinton Ave., North of Hotel Steel
(CR 3 Oct 1918, p9, c1)

ICE CREAM

Good health – economy—patriotism---each of these factors dictate that you eat plenty of ice cream, superior health value to more expensive foods. Get the habit of having Ice Cream for your

Sunday dessert.

Pints Enough for Four.

Quarts Enough for Eight.

BRUNNO MAZZOLINI & CO.

St. Johns, Michigan
Union Phone 306, 36 Clinton Avenue
(CR 3 Oct 1918, p9, c1)

SEEKING INFORMATION

On St. Johns Clubs circa 1925

1. O.N.E. Club
2. Hookah Club
3. Crescent Club
4. Coffee Pot Club
5. Treadwell Club
6. Black Cat Club
7. Tuesday Club
8. Thursday Club
9. Dyme Fyne Club
10. Ever Ready Club
11. Royal Club
12. No Home Dinner Bridge Club
13. Monday Night Dinner Club

Also any info on:

1. **Salvation Army facility** in St. Johns either at Ottawa Street or Clinton Avenue.
2. Does anyone know of existence of a quilt made at this factory: **Columbian Manufacturing Co.**, circa 1895-1916.

Contact the archive or Lynne Gregory if you have anything relating to the above inquiries.

Huh...Electric Shoes??

Recent Acquisitions

2018 SEPTEMBER-NOVEMBER:

CHURCH:

- Wooden attendance display for the Free Methodist Church, St. Johns; 22 x 36"

HISTORY:

- *Michigan's Looking Glass River by Kayak*, A Modern-Day Journey Down a Historic River; Ted M. **Reuschel**; Chapbook Press; 2018; 6 x 9"; soft cover; 144 pp.

ORAL HISTORY:

- Typed history and memories of the town and school of DeWitt, MI; memories of Marilyn (**Staub**) **Coin's** life; 2018; CD and white 3 ring binder, 188 pp

DIGITAL PHOTOS:

- Jeannie **GREEN**; 1954; 2 1/4 x 3"; b/w
 - Jeannie **GREEN**; 1954; 3 3/4 x 2 1/2"; color
 - Linda **MILLETTE**; 1954; 5 x 3 1/2"; color
 - Hoyt **DEGROOT**; 1954; 3 3/4 X 2 1/2"; color
 - PeriAnn **GASKILL**, Joyce **HARRIS**; 1954; 3 3/4 X 2 3/4"; color

PHOTOS:

- Clarence **VANSICKLE**; 5 3/4 x 9 3/4", b/w [T-28]
 - Verna **BEARUP**; 5 x 7"; b/w [T-29]
 - Rose & Frank **ATKINS**; 4 3/4 x 5 3/4"; b/w [T-30]
 - Bernice **JAKEWAY**; 5 1/2 x 8 1/4"; b/w [T-39]
 - Clarence W. **ALWARD**; 3 x 5"; b/w [T-31]
 - Mable **BORON**; 3 1/4 x 6 1/4"; b/w [T-32]
 - Myra **DOTY**; 3 1/2 x 7"; b/w [T-33]
 - Leona **KRUMM**; 6 x 8 1/2"; b/w [T-34]
 - Helen **PARR**; 5 x 6 3/4"; b/w [T-36]
 - Carmelita **LIETZKE**; 6 x 8 1/2"; b/w [T-37]
 - Edna **HANRATTA**; 1930; 3 3/4 x 5 3/4"; b/w [T-35]
 - Mary **WAIDELICH DENGLER**; mother of Florence & Fred; 6 x 9"; b/w [T-38]
 - Robert **POST**; 1945; Senior Photo; 5 x 7"; b/w [T-49]
 - Dick **CULVER**; 1945; Sr. Photo; 5 x 7"; b/w [T-50]
 - Duane **DAVIS**; 1945; Sr. Photo; 5 x 7"; b/w [T-51]
 - Doyne **HEUER**; 1945; Sr. Photo; 5 x 7"; b/w [T-52]
 - Steve **HOPKO**; 1945; Sr. Photo; 5 x 7"; b/w [T-53]
 - Kendall **KNIGHT**; 1945; Sr Photo; 5 x 7"; b/w [T-56]
 - Keith **ROSEKRANS**; 1945; Sr Photo; 5 x 7"; b/w [T-57]
 - Leo & Muriel **JUENKER's** house and children; 5 1/2 x 3 1/2"; b/w [J-65]
 - Fred & Julia **HILL**; 3 1/2 x 5 3/4"; b/w [T-47]
 - Ruth & Ken **PUTNAM**; (Grandma Smith's house) 4 1/4 x 2"; b/w [T-48]
 - Hattie **STRICKLAND**; 2 1/2 x 4"; b/w [T-42]
 - Hattie **STRICKLAND**; 2 1/2 x 4"; b/w [T-43]
 - Jessie **STRICKLAND**; 3 1/4 x 4 1/4"; b/w [T-40]

- M. Allida **STRICKLAND**; 2 1/2 x 4"; b/w [T-44]
 - Richard **MARSHALL**; 5 3/4 x 9 3/4"; b/w [J-58]
 - Sophia **SMITH**; 6 x 8 3/4"; b/w [T-45]
 - Gertie **JOSLIN**; 6 x 9"; b/w [T-46] - Myra & Edith **DOTY**; 5 1/2 x 7 1/2"; b/w [J-70]
 - Myra **DOTY**; 3 1/2 x 5 1/2"; b/w [J-66]
 - Myra **DOTY**; 3 1/2 x 5 1/2"; b/w [J-67]
 - Myra **DOTY**; 3 1/2 x 5 1/2"; b/w [J-68]
 - Myra **DOTY**; 5 1/2 x 8 1/2"; b/w [J-69]
 - Anna **Teare**; 6 x 9"; b/w [J-71]
 - Mrs. **PETERS**; 3 x 4 1/4"; b/w [J-72]
 - Freddie **DENGLER**; 4 1/4 x 8 1/2"; b/w [T-60]
 - Mary **Wrastler**; 6 x 8"; b/w [T-59]
 - Amanda **HOWERTH**; 6 x 9"; b/w [T-58]
 - Mary **BEHRENS**; 10 x 12"; b/w [T-57]

PLAT BOOK:

- 2015 Plat Book, Clinton County, Michigan; 8 1/2 x 11"; spiral bound; 79 pp.

POST CARDS:

- C.T. **Babcock's** residence, St. Johns (506 S. Oakland St.); early 1900's.
 - Court House, St. Johns; ca 1912
 - Court House, St. Johns, early 1900's

VERTICAL FILE:

- DeWitt Fire Department History; photo copies; 8 pp

VITAL RECORDS:

- Confirmation paper for Nettie A. **WITT**; b. 1904; conf. 1918; Riley Twp. 12 x 15"; heavy weight paper; color [VROD 357A]
 - Confirmation paper for Emma **STOEFFLER**; b. 1874; conf. 1915; Riley Twp; 12 x 16"; heavy weight paper; color [VROD 357B]
 - Confirmation paper for Louis E. **STOEFFLER**; b. 1899; conf. 1914; Riley Twp; 11 x 17"; heavy weight paper; colored [VROD 357C]
 - Baptism record for Johann Peter **STOEFFLER**; b. Aug. 1872; bapt. 1872; 8 1/2 x 10 1/2" brn/white [VROD 357D]
 - Confirmation paper for Johann Peter **STOEFFLER**; b. 1872; conf. 1888; 10 x 12"; b/w [VROD 357E]

NAMES RESEARCHED: Acre, Bentley, Blodget, Brown, Cooper, Frost, Hart, Keiser, Kimball, Ludington, Muller, Newman, Perisoe, Parks, Phelps, Pung, Shullenbarger, Smith, Stern, Tatroe, Thelen, Weaver. Also researched: Hayworth Creek, St. Johns Quilt & Cheesebutter factory.

THE CLINTON HOUSE

Contributed by Myrna VanEpps

Dr. **G[ilbert] E. Corbin**¹ Writes Interestingly Concerning St. Johns in the Sixties

St. Johns, Feb. 17, 1905. C. C. Vaughan, [Editor]-- Dear Sir: In your issue of yesterday, I notice a report of the death of **James F. Newton**. From August 1862 until January 1864, I boarded at the Clinton House, then owned and conducted by J. F. Newton and his very capable and estimable wife. Your informer is very greatly mistaken about the location of said hotel.

It was not a structure that by any possibility could have been crowded into the narrow limits of the lot designated. On the contrary, the hotel with its barn, out-buildings, and a small, enclosed yard of shrubs and flowers on the west, did occupy the whole of the block south of the **J. E. Bancroft** store and through east to Spring Street. The hotel barn, where I had two horses cared for as I was then engaged in the general practice of medicine, occupied the corner where the laundry building now stands. The south front of the hotel was entirely flush with the sidewalk on State Street, and the general business entrance to the hotel was there. Not really needing the ground on which the "Bancroft Store" (Leland's) is situated, Mr. Newton sold it to **Dewitt C. Hurd** who erected a two-story building on it, and while selling groceries on the first floor, he used the upper story as a residence for himself and family. Mr. Newton was pleasant, cordial, very active, -- an exceptionally successful landlord.

The house was a model of neatness, the table fare excellent, attracting, and holding probably not less than fifty steady boarders at that early day. Among them were **A. H. Walker** and his son **Samuel S.**, Mr. Walker's wife and daughter yet remaining in Detroit; **Henry M. Perrin** was then unmarried and made the Clinton House his home; **Henry S. Hilton**; **O. W. Munger**; and various others in business here made a jolly set of boarders at the old Clinton House.

To many of us it was a sad sight to see it go in one general conflagration that swept all before it until it reached the three-story, brick building now occupied by **S. A. Sturgis**, which was the first brick building erected on Clinton Avenue. That was built, owned, and occupied by **John W. Paine** who also erected, owned, and occupied the first brick dwelling house in St. Johns, the one now owned and occupied by **Dr. S. E. Gillam**. [Paine-Gillam-Scott Museum] Mr. Paine died there.

So far as I can ascertain, a large majority of the boarders and employees of the Clinton House at that period, like our landlord, are dead. You record the fact that Mr. Newton resided with his daughter, 1Mrs. **George L. Patch**. Her husband (who died years ago) at the early period in question, was also a boarder at the Clinton House and then was a clerk in the employ of O. W. Munger. G. E. Corbin; *Clinton Republican*; 23 Feb 1905; p1

JAMES F. NEWTON, well known to the earlier residents of St. Johns, died at his late home in St. Louis, Gratiot County, Saturday, February 11, of pneumonia, at the age of 83 years. Mr. Newton was a native of Ohio and came to St. Johns with his family in early history of the village. He purchased and for years conducted the Clinton Hotel., the house occupying the place where J. E. Bancroft's store now stands, and was the headquarters of the supervisors, jury, etc. Mr. Newton was an ardent Republican. He finally leased the hotel and moved to St. Louis where he has since resided. Mr. Newton is survived by two children, Arthur of California and Mrs. George L. Patch, with whom Mr. Newton resided. *The Clinton Republican*; 16 Feb 1905; p1

¹ Cecelia M. Newton m George L. Patch 12 Sept 1865 (*Clinton Republican*, Sept 1865, p3 c3)



Find us on
Facebook

We are now on Facebook. Follow us at CCHSMichigan to keep up to date on all of the latest happenings. It's also a great place to share your photos and memories!



The **Archives of the Clinton County Historical Society** is located at 16101 Brook Road in Dewitt Township Community Center. Volunteers are there to give research assistance from 9 a.m. to 4 p.m. on Mondays and Tuesdays and from 2 p.m. to 6 p.m. on Thursday. Phone: 517-482-5117 Ext. 2. E-mail: ccgensoc@yahoo.com Web page: dewittlibrary.org/CCHS. CCHS members have free usage of the Archives, non-member cost \$5.00 donation per day.

The **Historical Society** meetings are held on the first Monday of each month at 1:00 pm Nov. through March and at 7:00 p.m. Apr. through Oct. at the First United Methodist Church on State Street, at the northeast corner of the courthouse square in St. Johns, with entry through the south backdoors. Regular meetings are not held in June & December.

The **Paine-Gillam-Scott Museum** complex is located on the west side of the courthouse square in St. Johns. www.pgsmuseum.com. To join the Friends of the Museum, contact them at: pgsmuseum@hotmail.com; or PGS Museum, P.O. Box 174, St. Johns, MI 48879

HISTORICAL SOCIETY ARCHIVES MEMBERSHIP APPLICATION/RENEWAL

Mr./Mrs./Miss _____

List 5 Names you are Researching: _____

Address: _____

City: _____ State: _____ Zip _____

Phone: _____ New _____ Renewal _____

Do we have permission to share your information with other

E-Mail Address: _____

researchers: (please circle Yes or No on each):

Date: _____

Name & Address: Yes No

E-Mail: Yes No

Send me Clinton County Trails by e-mail _____ Yes _____ No

Annual Dues to join both the Clinton County Historical Society and the Genealogy Committee are \$15.00 single and \$20.00 a couple/family. Membership is based on the calendar year and includes a subscription to the quarterly newsletter, *Clinton County Trails*. Checks should be made payable to the Clinton County Historical Society and mailed to **P.O. Box 174**, St. Johns, MI 48879.

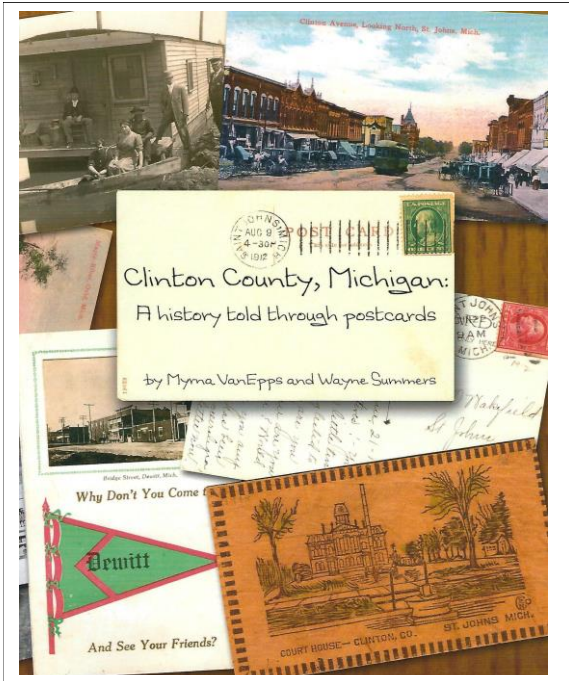

Clinton County Michigan: A history told through postcards has been sold out for several years. Due to popular demand, we are having a limited second printing. Copies will be available starting in October for \$20. Check out our webpage or Facebook page for information on how you can get a copy.

